

MKUH Update

Joe Harrison
Chief Executive

10th January 2017



- Activity growth
- Modular ward
- Main entrance
- Academic centre
- Off-site accommodation
- Cancer centre
- Car parking



Activity growth at MKUH

	2014/15	2015/16	Forecast 2016/17
A&E Attendances	78,415	84,056 +7%	88,817 +5%
Outpatients	339,358	366,499 +7%	395,568 +7%
Elective IP	23,162	24,375 +5%	27,071 +10%
Non-elective	24,037	25,432 +5%	27,203 +7%

Performance at MKUH

	2016/17 Year-to-date
A&E	Top 25%
Budget Performance	Top 10%
Waiting times	Top 25%
Mortality	Top 10%

Site Development at MKUH



- **Modular ward**
- Main entrance
- Academic centre
- Off-site accommodation
- Cancer centre
- Car parking



WeCARE

Modular ward

- 20 extra beds
- Next to theatres
- Temporary!

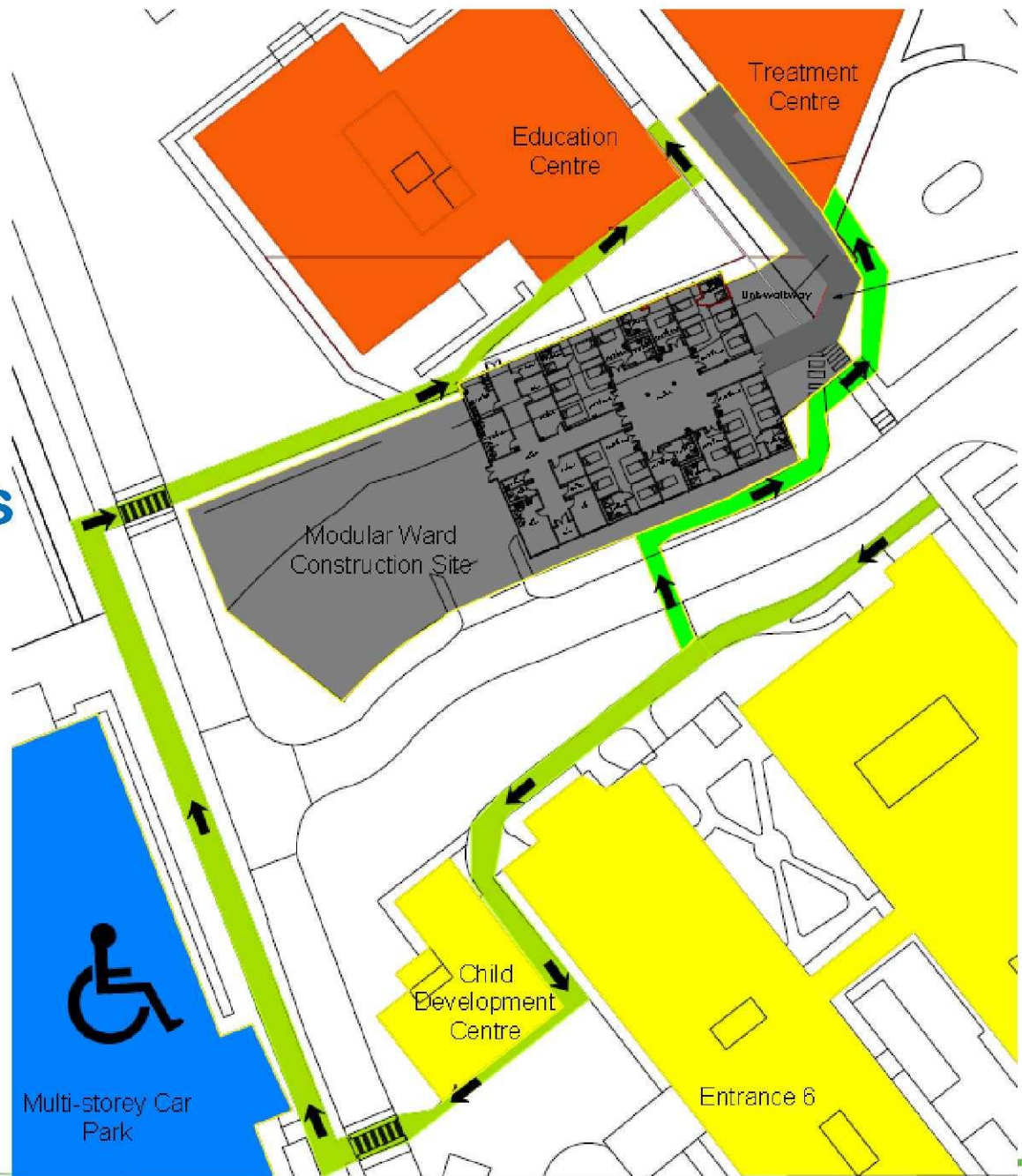

- Modular ward
- **Main entrance**
- Academic centre
- Off-site accommodation
- Cancer centre
- Car parking



Site Development at MKUH



WeCARE

New main entrance

Milton Keynes University Hospital 
NHS Foundation Trust



WeCARE

New main entrance



TOTAL GIA 939m²
TOTAL GFA 980m²

WeCARE

New main entrance

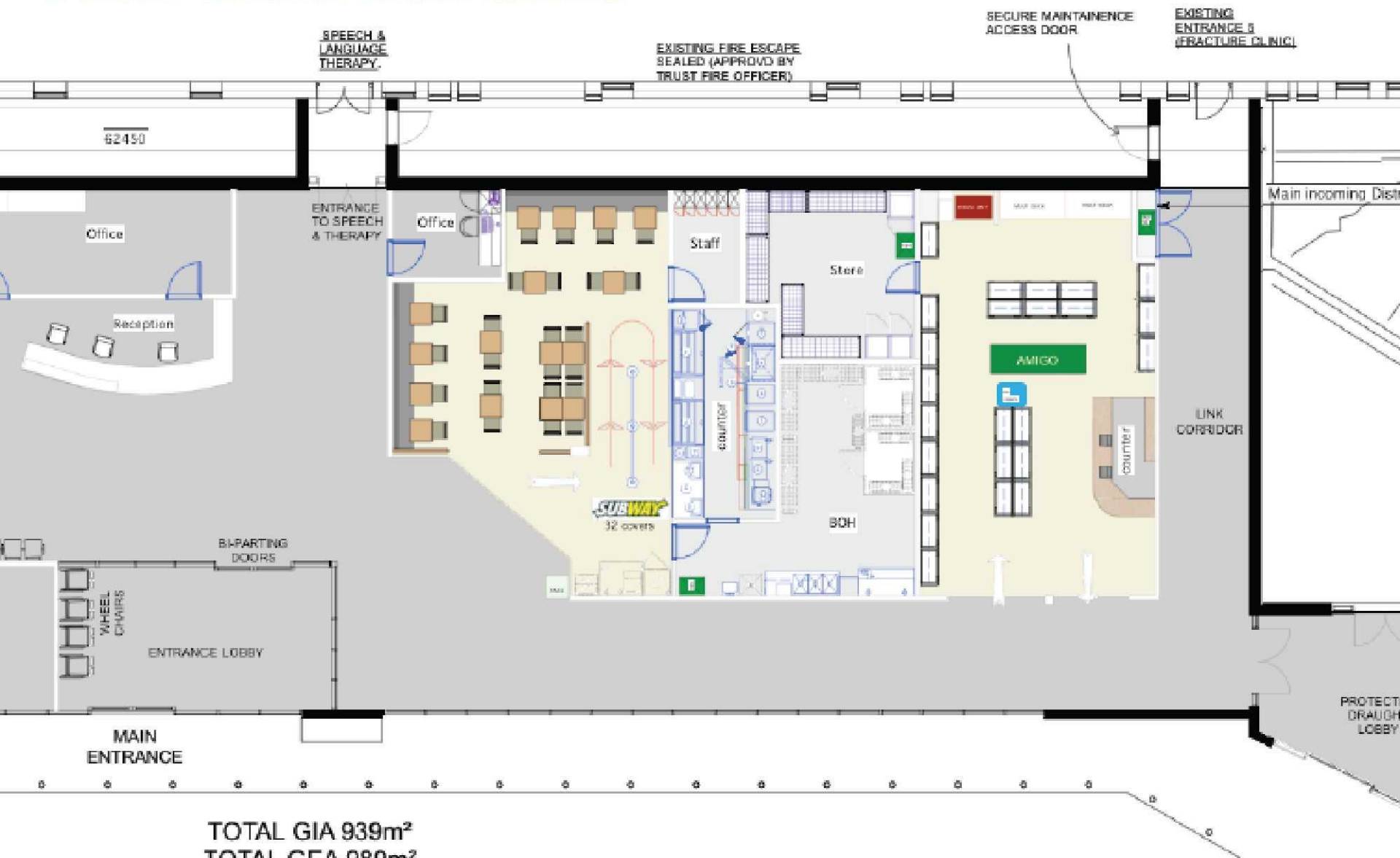

WeCARE

New main entrance

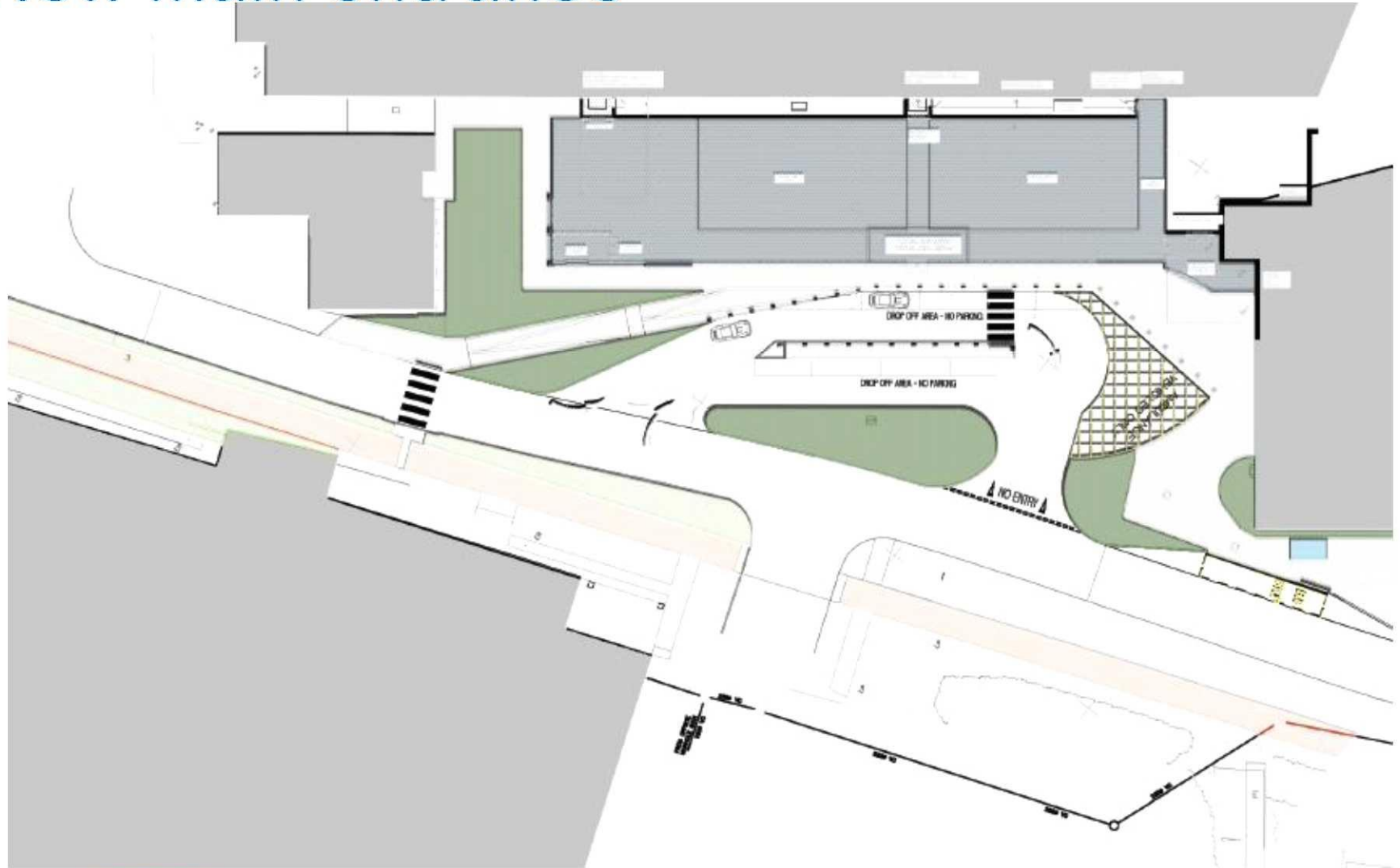

- Modular ward
- Main entrance
- **Academic centre**
- Off-site accommodation
- Cancer centre
- Car parking



WeCARE

Academic centre

Milton Keynes University Hospital



NHS Foundation Trust

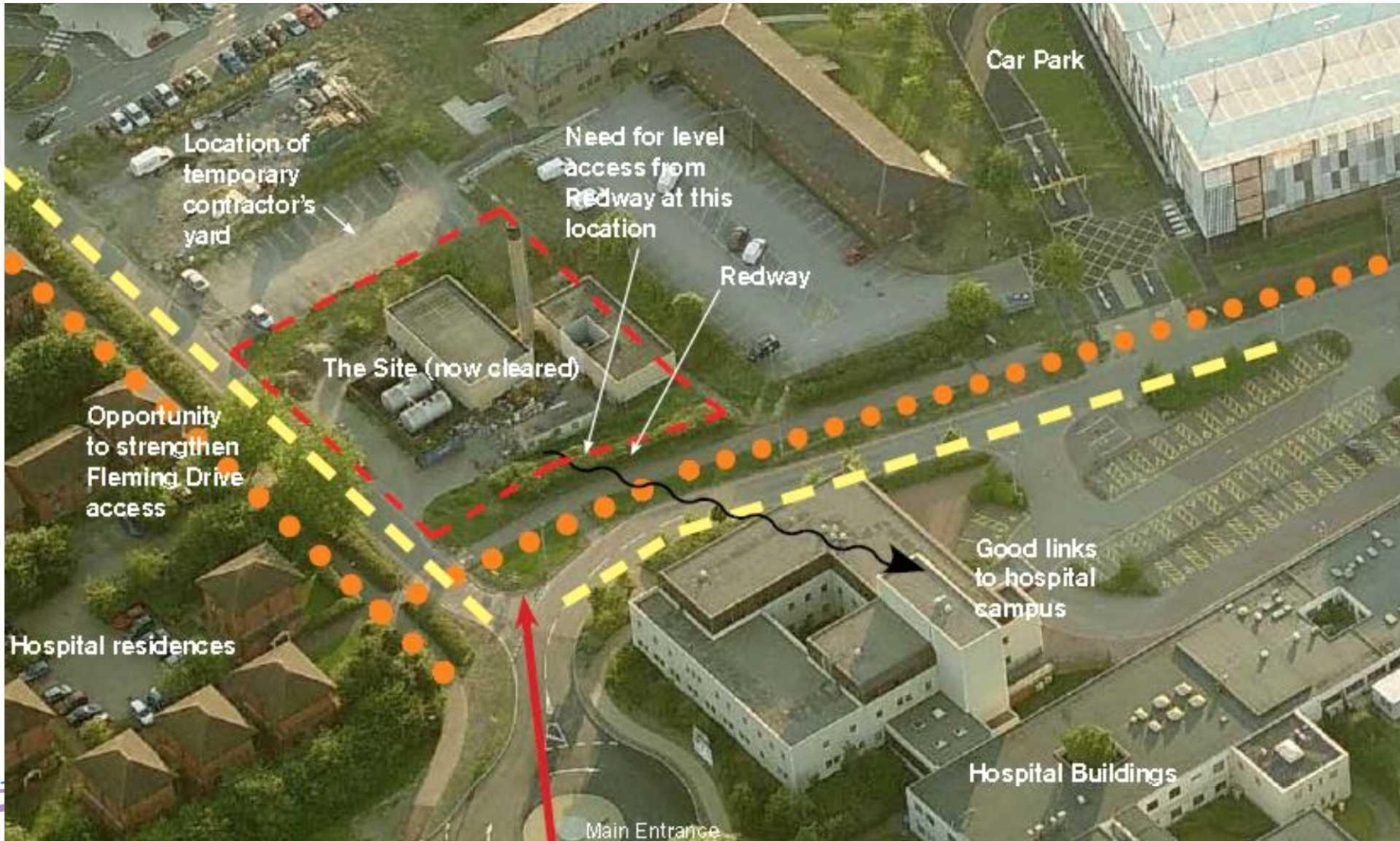

WeCARE

Academic centre

Milton Keynes University Hospital

NHS Foundation Trust



- Modular ward
- Main entrance
- Academic centre
- **Off-site accommodation**
- Cancer centre
- Car parking



- Modular ward
- Main entrance
- Academic centre
- Off-site accommodation
- **Cancer centre**
- Car parking



Site Development at MKUH



WeCARE Cancer Centre

Milton Keynes University Hospital
NHS Foundation Trust

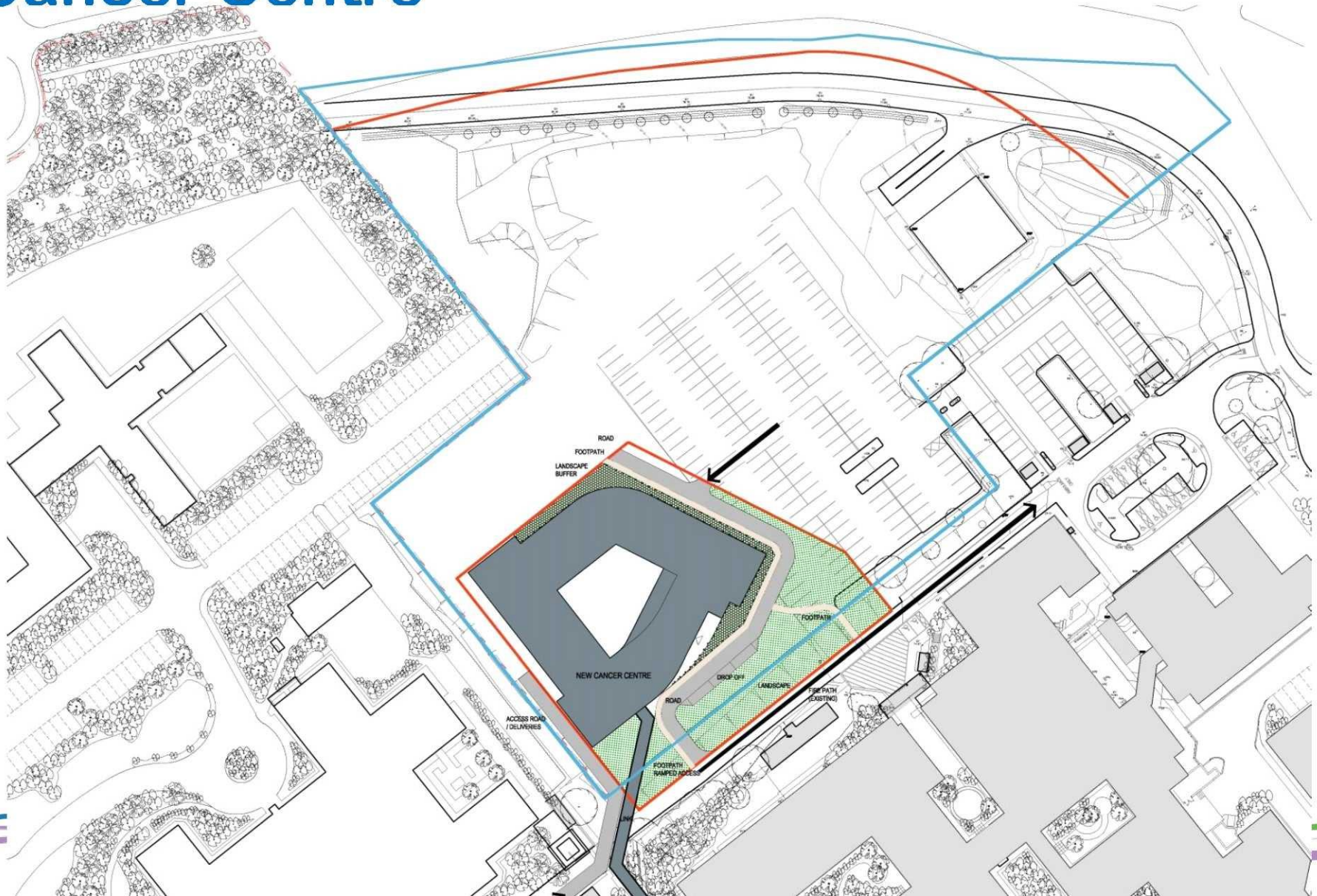

Cancer Centre

External Render – View 3 – Main Entrance



- Modular ward
- Main entrance
- Academic centre
- Off-site accommodation
- Cancer centre
- **Car parking**



Site Development at MKUH

